



**61 Conway Close, Houghton Regis, Dunstable, Bedfordshire, LU5 5SB  
£725 PCM**



- STUDIO APARTMENT
- GROUND FLOOR
- AVAILABLE JUNE 2026

- HOUGHTON REGIS
- PARKING ON SITE
- COMMUNAL GARDENS

- GREAT MODERN CONDITION THROUGHOUT
- MUST BE VIEWED
- EXCLUSIVE TO PR PROPERTY LETTINGS

Exclusive to P&R Property — This impressive studio apartment on Conway Close offers a surprisingly spacious and modern living experience, ideal for professionals or first-time renters looking for a stylish, low-maintenance home. Set on the ground floor with parking on site, the property benefits from a contemporary finish throughout and is available from June 2026. Nestled in a popular residential pocket of Houghton Regis, you're moments from Bedford Square shopping centre, a Morrisons supermarket, local bus routes, and swift access to the A5 and M1 — a genuinely convenient base that simply must be seen to be appreciated.

**LIVING ROOM 6'7" X 18'2" (2.00M X 5.54M)**

Two windows to side, Storage cupboard, double door, door to:

**BATHROOM**

**Ground Floor**

Approx. 24.6 sq. metres (264.5 sq. feet)

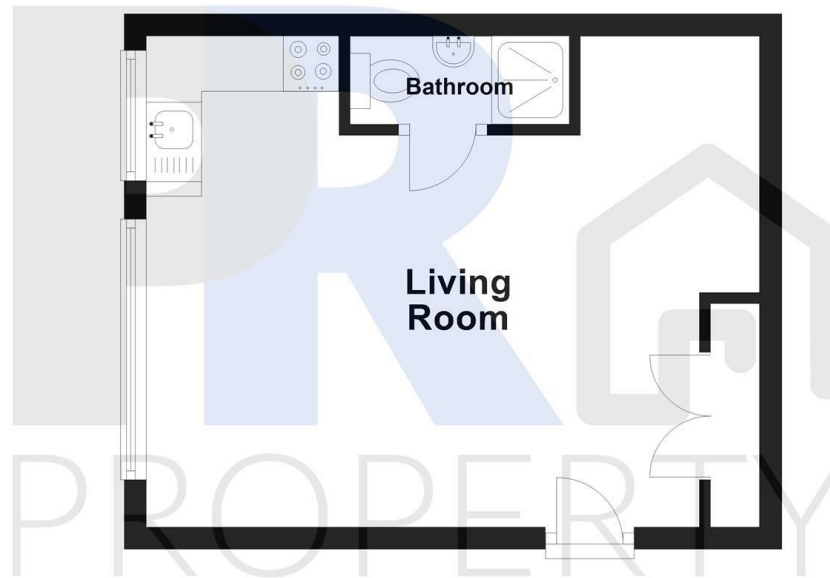

Total area: approx. 24.6 sq. metres (264.5 sq. feet)

**61 Conway Close, Luton**

Energy Efficiency Rating		Current	Potential
Very energy efficient - lower running costs			
(92 plus) A			
(81-91) B			
(69-80) C			
(55-68) D		64	79
(39-54) E			
(21-38) F			
(1-20) G			
Not energy efficient - higher running costs			
England & Wales		EU Directive 2002/91/EC	